

JUDGING PROGRAM

2010499301

9th Annual Terrier Group Show
(Unbenched)

EVERGLADES TERRIER CLUB

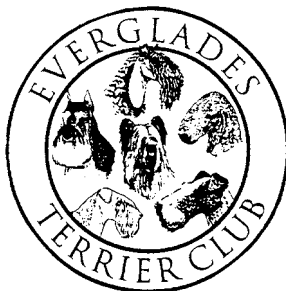

(American Kennel Club Licensed)

South Florida Fairgrounds
9067 Southern Blvd., West Palm Beach, FL 33411

FRIDAY, MARCH 12, 2010

SHOW HOURS: 9:00 A.M. TO 6:00 P.M.
All Judging Will Be Indoors (Air-Conditioned)
Obedience Classes Not Offered

A portion of the proceeds will benefit the Canine Health Foundation

New Exhibitors Briefing 10:00 A.M.

Best Bred by Exhibitor Competition
Junior Showmanship Competition

Supported Entries
Glen of Imaal Terrier Club of America
Central Florida Miniature Schnauzer Club



Pedigree IS THE OFFICIAL SPONSOR OF THIS EVENT



EQUIPMENT & SERVICE FURNISHED BY:

MB-F[®] Inc.

MB-F SHOW # 407

620 Industrial Ave. • P.O. Box 22107 • Greensboro, NC 27420 • 336-379-9352
32351 Edward Ave. • P.O. Box 9999 • Madison Hts., MI 48071 • 248-588-5000
FAX - 336-272-0864 • Internet Address <http://www.infodog.com>
E-Mail Address mbf@infodog.com

AMERICAN KENNEL CLUB ANNUALLY LICENSED SUPERINTENDENT
Member of the Dog Show Superintendents Association • dogshowsupers.org

"Please feel free to come by and take a tour of our Headquarters Office in NC any business day Mon. thru Fri., 9:00 A.M. to 4:00 P.M."

INDEX OF BREEDS

This index has been prepared to enable exhibitors to (1) identify the Ring(s) in which their Breed(s) is (are) to be judged and (2) have an approximation of the number of dogs entered. The entry figures are not to be taken as a representation on the part of the Superintendent/Show Secretary that all dogs entered will be present on the Show day.

Entry	Breed	Ring	Time	Entry	Breed	Ring	Time
8	American Staffordshire Terriers	4	11:00	1	Manchester Terriers (Standard)	4	11:00
1	Australian Terriers	4	11:00	42	Miniature Schnauzers	5	1:15
1	Bedlington Terriers	4	2:15	4	Norfolk Terriers	4	11:45
4	Border Terriers	4	11:00	1	Norwich Terriers	4	11:00
1	Bull Terriers (White)	4	1:15	3	Russell Terriers	4	11:45
2	Cairn Terriers	4	11:00	12	Scottish Terriers	4	1:15
2	Dandie Dinmont Terriers	4	2:15	1	Sealyham Terriers	4	2:15
2	Fox Terriers (Smooth)	4	11:00	1	Skye Terriers	4	2:15
10	Glen of Imaal Terriers	4	11:45	5	Soft Coated Wheaten Terriers	4	1:15
3	Junior Showmanship Competition	4	2:15	7	Staffordshire Bull Terriers	4	1:15
10	Kerry Blue Terriers	4	2:15	2	Welsh Terriers	4	11:45
3	Lakeland Terriers	4	2:15	1	West Highland White Terriers	4	2:15

PROGRAM OF JUDGING

There are 126 dogs entered in this All Terrier Show with a total entry of 127 in 24 different Breeds or Varieties. For your convenience, the following division of sexes has been carefully tabulated; however, neither the Club nor the Superintendent/Show Secretary assumes responsibility for absolute accuracy.

The number before each Breed (Variety) indicates the number of dogs entered in that Breed (Variety). The numbers following each Breed (Variety) indicate the number of Regular Class Dogs, Regular Class Bitches, Best of Breed (Variety) (Dogs-Bitches), and Non-Regular Class Dogs or Bitches.

RING FOUR

JUDGE: Mrs. Marcia Feld

11:00 AM

- 1 - Australian Terriers 1-0-(0-0)
- 1 - Norwich Terriers 0-0-(1-0)
- 1 - Manchester Terriers (Standard) 0-0-(1-0)
- 2 - Fox Terriers (Smooth) 0-0-(1-1)
- 2 - Cairn Terriers 0-1-(1-0)
- 4 - Border Terriers 0-2-(2-0)
- 8 - American Staffordshire Terriers 1-4-(2-1)

11:45 AM

- 3 - Russell Terriers 2-1-(0-0)
- Best in Miscellaneous Class
- 2 - Welsh Terriers 1-1-(0-0)
- 4 - Norfolk Terriers 1-3-(0-0)
- 10 - Glen of Imaal Terriers 4-4-(1-1)

12:30 PM

Lunch

1:15 PM

- 12 - Scottish Terriers 4-6-(2-0)
- 1 - Bull Terriers (White) 0-1-(0-0)
- 5 - Soft Coated Wheaten Terriers 0-1-(2-2)
- 7 - Staffordshire Bull Terriers 3-3-(1-0)

2:15 PM

- 1 - Bedlington Terriers 0-0-(1-0)
- 1 - Skye Terriers 0-0-(1-0)
- 1 - Sealyham Terriers 1-0-(0-0)
- 1 - West Highland White Terriers 0-0-(1-0)
- 2 - Dandie Dinmont Terriers 1-1-(0-0)
- 3 - Lakeland Terriers 0-2-(0-1)
- 10 - Kerry Blue Terriers 0-3-(4-3)

Junior Showmanship Competition

- 1 - Novice Junior
- 1 - Open Intermediate
- 1 - Open Senior
- Best Junior Handler

85 Total Dogs

RING FIVE

JUDGE: Mr. Barry Day

1:15 PM

- 42 - Miniature Schnauzers 10-22-(8-2)

42 Total Dogs



RING FOUR

3:30 PM

(The groups will be judged in the following order unless otherwise announced)

Bred By Exhibitor Terrier Group..... 87 Sherwood Ave., St. Albans, Hertfordshire, ENG AL4 9DH Mr. Barry Day

Best in Group..... 1054 Tamarack Ln., Libertyville, IL 60048 Mrs. Marcia Feld

JUDGES

Mr. Barry Day (Ring 5)..... 87 Sherwood Ave., St. Albans, Hertfordshire, ENG AL4 9DH

Mrs. Marcia Feld (Ring 4)..... 1054 Tamarack Ln., Libertyville, IL 60048

IMPORTANT - TRANSFER of dogs from regular classes to Best of Breed/Variety Competition (Ch. 11 Section 6, AKC Rules) MUST be made to the Superintendent/Show Secretary at least one half hour prior to the start of any regular conformation judging at this show. TRANSFERS by Junior Handlers from Novice to Open Class MUST be made to the Superintendent/Show Secretary at least one half hour prior to the scheduled start of Junior Showmanship judging at the show. SUBSTITUTIONS of Junior Showmanship dogs must be made at least one half hour prior to the judging of any Junior Showmanship classes at the show.

☆☆ Best Bred by Exhibitor in Group Competition ☆☆

The winners of the Bred by Exhibitor Dog and Bred by Exhibitor Bitch Classes in each Breed/Variety will compete for Best Bred by Exhibitor in Breed following Best of Breed/Variety judging in each breed. (If the Best of Breed/Variety or Best of Winners is the winner of a Bred by Exhibitor Dog or Bred by Exhibitor Bitch Class, that dog/bitch is automatically Best Bred by Exhibitor in that Breed/Variety). The Best Bred by Exhibitor in each Breed/Variety will compete for Best Bred by Exhibitor in Group.

The club reserves the right to hold Best Bred by Exhibitor judging concurrently with regular Group Judging.

Attention New Exhibitors

A new Exhibitor Briefing will be held in Ring 4 at 10:00 AM.
Spectators are welcome to attend.

Official Photographer

Kim Booth, Booth Photography, Inc.

P.O. Box 308, Williamston, MI 48895 (517) 655-4081

(Only the Official Photographer may be in the ring to take win pictures.)

Veterinarian On Call

Dr. Leonid Vidrevich

3200 N. Military Trail

West Palm Beach, FL

(561) 686-3663

Emergency Animal Clinic

(Open 24 hours, including weekends)

*Palm Beach Veterinary Referral & Critical Care Center

3092 Forest Hill Blvd., West Palm Beach, FL

(561) 434-5700

***Directions:** From Gate 12, turn left, go South to Southern Blvd. Go East to Military Trail, turn right, go South to Forest Hill Blvd. Turn left onto Forest Hill Blvd., go 1.6 miles. Clinic will be on the right (South) side of the road.

"Exhibitors should follow their veterinarians' recommendation to assure their dogs are free of internal and external parasites, any communicable diseases, and have appropriate vaccinations."

NOTE:

To find out about any AKC event cancellations call the AKC Event Cancellation Hotline (877) 252-3229.

Ramps at the sole discretion of the judge, approved breeds may be examined on the ground or on a ramp: Irish Terriers, Kerry Blue Terriers, Soft Coated Wheaten Terriers & Staffordshire Bull Terriers.

This list may be revised from time to time, and the current list can be found on the AKC website in Judging Operations.

A judge requesting the use of a ramp must give reasonable notice to the Show Superintendent/Show Secretary prior to the day of the show. AKC approval is not required.

Ramps may be used in emergency situations to judge any breed. (In all but emergency situations, the exhibitor has no recourse. In an emergency situation, where use of a ramp is not indicated in the premium list, an exhibitor has the option of withdrawing their entry and receiving a refund.)

NOTICE

JUNIORS WHO SUBSTITUTE FOR THE ORIGINAL DOG THEY HAVE ENTERED IN THE JUNIOR SHOWMANSHIP CLASSES WITH DOGS THAT ARE NOT ENTERED IN ONE OF THE OFFERED CLASSES AT THIS SHOW MUST REMIT THE JUNIOR SHOWMANSHIP ONLY ENTRY FEE WITH THEIR SUBSTITUTION.

Attention Exhibitors

Please leave grounds in the condition you found them. Place all trash in bags and deposit in the trash containers before leaving so we may have the grounds again in the future. Crates and all tables allowed at ringside only during the judging of that specific breed. NO EXCEPTIONS.



Pedigree

BRAND

®

Food For Dogs

NOTE: To collect your PEDIGREE® prize, the appropriate winning ribbon must be presented at the PEDIGREE® Booth by 5:00 P.M. on the day of the show.

NO PRACTICING ALLOWED IN RINGS AT ANY TIME.

Dogs May Arrive any time prior to their scheduled time of judging. **Dogs not required for further judging will be excused.**

Judges Will Not Wait for Any Dog Holding Up a Class. Owners or agents alone are responsible for the presence of their dogs in the judging ring when their classes are called to be judged.

All Dogs Present must be held on leash or confined to their crates except when being judged or when in the exercising ring.

No gasoline or diesel generators are permitted inside any building or within 100 feet of any tent in which this dog show is conducted.

As specified in Chapter 12, Section 4 of the AKC Rules Applying to Dog Shows, information contained on the entry form is required to be published in the club's show catalog. This information is also subject to publication in other media.

Entry Fees shall not be refunded in the event that a dog is absent, disqualified, excused by Veterinarian or Judge, or barred from competition by action of the event's Show Committee. If because of riots, wars, strikes, civil disturbances, national emergencies, health emergencies, and the dictates of law enforcement or of the owner(s) of the grounds and/or facilities or other acts beyond the control of the management it is impossible to open or to complete the show, no refund of entry fee will be made. Extreme weather conditions, such as, but not limited to, snow storms, hurricanes, lightning, extreme heat, heavy rains, or other circumstances including, but not limited to, the condition of the facilities or grounds and/or the ingress and egress from the grounds, must be considered for the health and safety of the dogs, exhibitors and spectators. The well-being of dogs, exhibitors and spectators is of paramount importance and, in the event it is necessary to cancel or stop the show before completion, no refund of entry fee will be made.

Accommodations

Get Lowest Rates Here

Call 1-800-780-5733 and use discount code 252688 or go to infodog.com/travel/ to get the lowest rate with a price match guarantee.

Hotels in Palm Beach County are at an all time low for our shows

The club has negotiated special room rates with the following dog friendly hotel that are at an all time low:

- Days Inn**, 2300 West 45th St. (-I-95 at 45th St.), West Palm Beach, FL 33407 (800) 543-1613
 \$75.00 per night - No Pet Fee
- LaQuinta Inn & Suites West Palm Beach**, 1910 Palm Beach Lakes Blvd., W. Palm Beach, FL 33409.... (561) 689-8540
 \$87.00 per night - No Pet Fee or (800) 531-5900
- Holiday Inn Palm Beach Airport**, 1301 Belvedere Rd., West Palm Beach, FL 33405 (561) 659-3881
 \$89.00 per night - \$25.00 Pet Fee
- Residence Inn**, 2461 Metrocentre Blvd., West Palm Beach, FL 33407..... (561) 687-4747
 \$109.00 per night - Includes Hot Buffet Breakfast - Large Suites with fully equipped kitchen (microwave, full-size fridge, stovetop) - No pet fee - Dogs 80 lbs. & under -
 Reservations before February 28, 2010 reference "Dog Show" - After February 28, 2010 ask for Erika Hansen.

Other Hotels

- Treetop Motel**, 5475 Lake Worth Rd., Greenacres, FL 33463..... (561) 965-2106
- Motel 6 - Lantana**, 1310 W. Lantana Rd., Lantana, FL 33462 (561) 585-5833
 No Pet Fee
- LaQuinta**, 5981 Okeechobee Blvd., West Palm Beach, FL 33417 (800) 531-5900
- Comfort Inn**, 1901 Palm Beach Lakes Blvd., West Palm Beach, FL 33409 (561) 689-6100

Host Hotel - American Miniature Schnauzer Club, Inc.

Ask for AMSC block of rooms - \$25.00 Pet Fee

- Royal Inn**, 675 Royal Palm Beach Blvd., Royal Palm Beach, FL 33411 (561) 793-3000
- Martiniue Motor Lodge**, 801 Dixie Hwy., Lake Worth, FL 33460 (561) 585-2502

Exhibitor, please be responsible, take care of rooms & hotel grounds so we will be invited back.

Routes to the Show

From North or South - I-95 to Southern Blvd. - Turn West and proceed West to Fairgrounds.

Turnpike - Exit 97 - Southern Blvd. - Turn West and proceed to Fairgrounds.

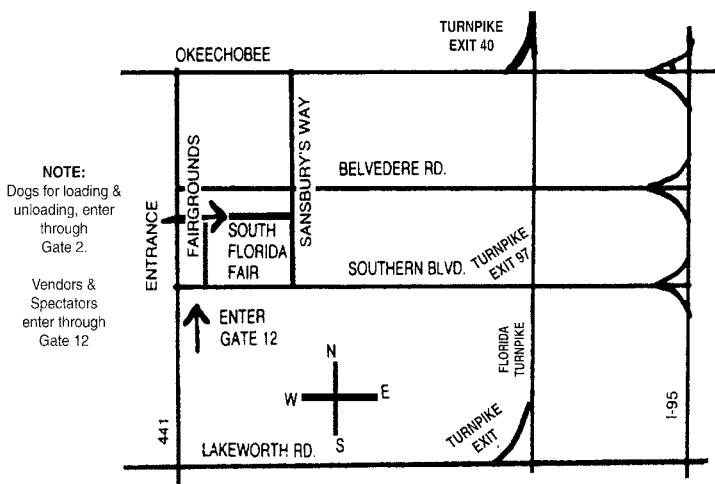

Attention Exhibitors

Show location is available 7:00 A.M. Friday, March 12, 2010.

Exhibitors enter at Gate 2 for loading and unloading.

Lights must be left on while unloading.

Camping will be permitted at the Fairgrounds. Areas of parking available starting on Thursday, March 11, 2010.

Absolutely NO tent camping allowed.

Hookups including water, sewer & electricity available at \$40.00 per night on a first come, first served basis.

Motor Home sites are narrow. X-pens must be set up within your site.

Parking Day of the show - \$5.00.

All parking fees controlled by Fairgrounds.

Paramedic on site during show hours.

The Event Committee has the authority to change the rules for the safety and control of dogs & exhibitors.

The Event Committee reserves the right to require the stacking of crates and any other remedies it may deem necessary for consolidating space on a case-by-case basis at their discretion.

DO NOT LEAVE DOGS IN CLOSED VEHICLES.

Aisles must be kept open in the Grooming and Showing areas.

The buildings will be locked at night.

Loss or Damage Disclaimer: The club will assume NO responsibility for any personal injury or death to any person; theft, damages or loss of personal property nor injury or death of any animal either at or on the show grounds. It is expressly understood that every dog at this show is in the care and custody and control of his/her owner or handler during the entire time the dog is on the show premises.

Overnight Roaming Security will be provided.

Grooming allowed in designated areas only.

No dogs, feed bowls or grooming utensils allowed in the restrooms.

Only handicapped people may use motorized chairs inside the buildings.

No strollers, wagons, buggies, golf carts, skates, bicycles or scooters will be allowed inside the buildings.

No unentered dogs will be allowed on the show grounds during show hours.

Puppies under the age of six months are prohibited on the show grounds during show hours.

A parent is responsible for the welfare of the child and any damages done by the child.

The club is not responsible for the products or actions of Vendors exhibiting at this show.

CRATES, GROOMING TABLES, RINGSIDE TABLES OR RESTING TABLES ALLOWED AT RINGSIDE ONLY DURING THE JUDGING OF THAT SPECIFIC BREED AND MUST BE REMOVED IMMEDIATELY UPON COMPLETION OF THAT SPECIFIC BREED.

All private exercise pens must be setup in designated areas only.

Roping off or saving of crating space is not allowed.

Exhibitors and handlers will be held responsible for clean conditions in and around their crates and parking spaces.

NO DOGS ARE ALLOWED TO BE LEFT IN THE BUILDING OVERNIGHT.

Anyone causing undue disturbance will be asked to leave the show grounds.

Private exercise pens are not allowed in the show buildings.

All dogs must be kept under control at all times. For this reason, we strongly suggest that flexi-leads not be used on the show grounds.



9067 Southern Blvd.
 PO Box 210367
 West Palm Beach, FL 33421-0367
 (561) 793-0333
 Fax (561) 790-5210
 Website: www.southfloridafair.com



The South Florida Fair has a limited number of Camping Spaces available for this event. They will be assigned on a first come/first served basis. Each camping space has electrical, water and sewer hookups. Campers must bring their own cords and connections. Please check in with security for your space assignment.

Camping Cost: \$40.00 Per Night

**Exhibitors & Motor homes - Enter Gate 2 for loading and unloading.
 All others Enter Gate 12.**



Special Notice Crating Regulations

Any dog in a crate on the Show Grounds must be identified with Owner/Agent contact.
Complete form below and attach to crate.

In an effort to accommodate exhibitors within our limited space, we are allowing crates at ringside. All crates will be allowed ringside ONLY during judging of that breed and must abide by the following:

Crates must be accompanied by an ID Tag with name of owner/handler:

Dog crates must be removed immediately after judging. No dog crate will be allowed on the show grounds without an ID Tag. Please help us keep this privilege.

AGENT FOR THIS DOG

BREED OF THE DOG

RING TIME

AKC Code of Sportsmanship

PREFACE: The sport of purebred dog competitive events dates prior to 1884, the year of AKC's birth. Shared values of those involved in the sport include principles of sportsmanship. They are practiced in all sectors of our sport: conformation, performance and companion. Many believe that these principles of sportsmanship are the prime reason why our sport has thrived for over one hundred years. With the belief that it is useful to periodically articulate the fundamentals of our sport, this code is presented.

- Sportsmen respect the history, traditions and integrity of the sport of purebred dogs.
- Sportsmen commit themselves to values of fair play, honesty, courtesy, and vigorous competition, as well as winning and losing with grace.
- Sportsmen refuse to compromise their commitment and obligation to the sport of purebred dogs by injecting personal advantage or consideration into their decisions or behavior.
- The sportsman judge judges only on the merits of the dogs and considers no other factors.
- The sportsman judge or exhibitor accepts constructive criticism.
- The sportsman exhibitor declines to enter or exhibit under a judge where it might reasonably appear that the judge's placements could be based on something other than the merits of the dogs.
- The sportsman exhibitor refuses to compromise the impartiality of a judge.
- The sportsman respects the AKC bylaws, rules, regulations and policies governing the sport of purebred dogs.
- Sportsmen find that vigorous competition and civility are not inconsistent and are able to appreciate the merit of their competition and the effort of competitors.
- Sportsmen welcome, encourage and support newcomers to the sport.
- Sportsmen will deal fairly with all those who trade with them.
- Sportsmen are willing to share honest and open appraisals of both the strengths and weaknesses of their breeding stock.
- Sportsmen spurn any opportunity to take personal advantage of positions offered or bestowed upon them.
- Sportsmen always consider as paramount the welfare of their dog.
- Sportsmen refuse to embarrass the sport, the American Kennel Club, or themselves while taking part in the sport.



**AMERICAN
KENNEL CLUB™**