

# JUDGING PROGRAM

2010230001

2010230002

Specialty Show, Sweepstakes, Veteran Sweepstakes,  
All-Breed Obedience Trial & All-Breed Rally Trial  
(Unbenched)

## Everglades Golden Retriever Club, Inc.



(American Kennel Club Licensed)

South Florida Fairgrounds, Expo Center  
9067 Southern Blvd., West Palm Beach, FL 33411

### Friday, March 12, 2010

ALL JUDGING WILL BE HELD INDOORS  
SHOW & TRIAL HOURS: 9:00 A.M. TO 8:00 P.M.

Parking On Grounds Available Thursday Night  
Grounds Available 7:00 A.M. Friday

Grooming Space Available No Earlier Than 7:00 A.M. Friday

EQUIPMENT & SERVICE FURNISHED BY:



**MB-F** Inc.

MB-F  
SHOW  
# 1116

620 Industrial Ave. • P.O. Box 22107 • Greensboro, NC 27420 • 336-379-9352  
32351 Edward Ave. • P.O. Box 9999 • Madison Hts., MI 48071 • 248-588-5000  
FAX - 336-272-0864 • Internet Address <http://www.infodog.com>  
E-Mail Address [mbf@infodog.com](mailto:mbf@infodog.com)

AMERICAN KENNEL CLUB ANNUALLY LICENSED SUPERINTENDENT

Member of the Dog Show Superintendents Association • [dogshowsupers.org](http://dogshowsupers.org)

*"Please feel free to come by and take a tour of  
our Headquarters Office in NC any business  
day Mon. thru Fri., 9:00 A.M. to 4:00 P.M."*

## PROGRAM OF JUDGING

There are 154 dogs entered in this Specialty Show & Trials with a total entry of 220, including 63 obedience entries and 26 rally entries. For your convenience, the following class divisions have been carefully tabulated; however, neither the Club nor the Superintendent/Show Secretary assumes responsibility for absolute accuracy.

In accordance with Chapter 7, Section 8, of "Rules Applying to Dog Shows" and with American Kennel Club approval the following change applies:

<u>Breed</u>	<u>Original Judge</u>	<u>New Judge</u>
Retrievers (Golden) Breed Classes	Mr. Bruce Wylie	Dr. Maureen Shaughnessy

### RING SIX

**JUDGE: Ms. Patricia Flanagan**

**10:00 AM**

Specialty

- 31 - Retrievers (Golden) Sweepstakes (11-20)
- 5 - Retrievers (Golden) Veteran Sweepstakes (2-3)

36 Total Dogs

### RING SIX

**JUDGE: Mr. Joseph F. Joly III**

**11:45 AM**

**Junior Showmanship Competition**

- 1 - Novice Senior
- 2 - Open Intermediate  
Best Junior Handler

3 Total Dogs

### RING SIX

**JUDGE: Dr. Maureen Shaughnessy**

**1:00 PM**

Specialty

- 92 - Retrievers (Golden) 30-41-(8-2)
- 2 - Veteran Dogs
- 5 - Veteran Bitches
- 2 - Hunting Retriever Dogs
- 1 - Hunting Retriever Bitch
- 1 - Stud Dog

92 Total Dogs

**Obedience/Rally Contact:  
Linda Share (954) 993-7935**

### RING SEVEN

**JUDGE: Mrs. Patricia R. Krause**

**(Judge will take a one hour luncheon  
break at her discretion)**

**9:30 AM**

**A walk-thru prior to the start of the Novice Class  
A will be allowed for handlers without their dogs**

- 4 - Novice Class A Obedience Entries  
Nos 33 38 45 52

**10:15 AM**

- 13 - Open Class B Obedience Entries  
Nos 29 6 16 37 41 7 35 19 20 22 32 17 40

**11:55 AM**

- 9 - Open Class A Obedience Entries  
Nos 44 12 43 21 47 36 54 39 48

**To Follow**

- 2 - Wild Card Open  
Nos 49 11

**To Follow**

- 2 - Veterans Class  
Nos 28 34

**To Follow**

- 1 - Wild Card Novice  
Nos 25

**To Follow**

- 4 - Pre-Novice  
Nos 18 23 25 55

### RING EIGHT

**JUDGE: Mr. Harold Lavene**

**(Judge will take a one hour luncheon  
break at his discretion)**

**9:30 AM**

- 9 - Utility Class B Obedience Entries  
Nos 6 37 41 7 35 19 20 32 17

**10:50 AM**

- 4 - Utility Class A Obedience Entries  
Nos 15 30 14 42

**11:25 AM**

- 5 - Novice Class B Obedience Entries  
Nos 9 46 50 51 53

**To Follow**

- 2 - Versatility Class Obedience Entries  
Nos 41 10

**To Follow**

- 8 - Wild Card Utility  
Nos 26 27 8 16 14 42 24 31

### RING EIGHT

**JUDGE: Mrs. Carol M. Harrison**

**2:45 PM**

Rally Excellent Class A & B/Walk Thru

**2:55 PM**

- 3 - Rally Excellent Class A  
Nos 22 23 24

**To Follow**

- 7 - Rally Excellent Class B  
Nos 14 15 16 17 18 19 20

Rally Advanced Class A & B/Walk Thru

**To Follow**

- 3 - Rally Advanced Class A  
Nos 10 11 12

**To Follow**

- 8 - Rally Advanced Class B  
Nos 14 15 16 17 18 19 20 21

Rally Novice Class A & B/Walk Thru

**To Follow**

- 1 - Rally Novice Class A  
Nos 5

**To Follow**

- 4 - Rally Novice Class B  
Nos 6 7 8 9

## JUDGES

Ms. Patricia Flanagan (Ring 6) .....	5200 Bushnell Campbell Rd., Kinsman, OH 44428
Mrs. Carol M. Harrison (Ring 8) .....	4750 S.W. 22nd Pl., Ocala, FL 34474
Mr. Joseph F. Joly III (Ring 6) .....	863 Hawksbill Island Dr., Satellite Beach, FL 32937
Mrs. Patricia R. Krause (Ring 7) .....	4329 Islandview Rd., Rhinelander, WI 54501
Mr. Harold Lavene (Ring 8) .....	39093 Citadel Cir., Zephyrhills, FL 33542
Dr. Maureen Shaughnessy (Ring 6) .....	W168 N11318 Western Ave., Germantown, WI 53022

**IMPORTANT** - TRANSFER of dogs from regular classes to Best of Breed/Variety Competition (Ch. 11 Section 6, AKC Rules) MUST be made to the Superintendent/Show Secretary at least one half hour prior to the start of any regular conformation judging at this show. TRANSFERS by Junior Handlers from Novice to Open Class MUST be made to the Superintendent/Show Secretary at least one half hour prior to the scheduled start of Junior Showmanship judging at the show. SUBSTITUTIONS of Junior Showmanship dogs must be made at least one half hour prior to the judging of any Junior Showmanship classes at the show. MOVE UP OF DOGS IN OBEDIENCE/RALLY CLASSES (Ch. 1 Section 16 of Obedience Regulations) The request for a move up must be in writing and presented to the Superintendent/Trial Secretary at least 30 minutes prior to the start of each trial. Move ups for Obedience may be approved, provided the next level class and judge are available and the class has not reached its limit.

---

### On Call & 24 Hour Emergency Animal Clinic (Open 24 Hours, Including Weekends)

Palm Beach Veterinary Referral & Critical Care Center  
3092 Forest Hill Blvd., West Palm Beach, FL  
(561) 434-5700

**\*Directions:** From Gate 12, turn Left, go South to Southern Blvd., go East to Military Trail, turn Right, go South to Forest Hill Blvd., turn Left onto Forest Hill Blvd., go 1.6 miles. Clinic will be on the Right (South) side of the road.

### Medical Technician on Site

#### Official Photographer

Kim Booth, Booth Photography, Inc.  
P.O. Box 308, Williamston, MI 48895  
(517) 655-4081

(Only the Official Photographer may be in the ring to take win pictures.)

***“Exhibitors should follow their veterinarians’ recommendation to assure their dogs are free of internal and external parasites, any communicable diseases, and have appropriate vaccinations.”***

---

### NOTE:

To find out about any AKC event cancellations call the AKC Event Cancellation Hotline (877) 252-3229.

**A judge requesting** the use of a ramp must give reasonable notice to the Show Superintendent/Show Secretary prior to the day of the show. AKC approval is not required.

**Ramps may be used** in emergency situations to judge any breed. (In all but emergency situations, the exhibitor has no recourse. In an emergency situation, where use of a ramp is not indicated in the premium list, an exhibitor has the option of withdrawing their entry and receiving a refund.)

### NOTICE

**JUNIORS WHO SUBSTITUTE FOR THE ORIGINAL DOG THEY HAVE ENTERED IN THE JUNIOR SHOWMANSHIP CLASSES WITH DOGS THAT ARE NOT ENTERED IN ONE OF THE OFFERED CLASSES AT THIS SHOW MUST REMIT THE JUNIOR SHOWMANSHIP ONLY ENTRY FEE WITH THEIR SUBSTITUTION.**



IS THE OFFICIAL SPONSOR OF THESE EVENTS



## NO PRACTICING ALLOWED IN RINGS AT ANY TIME.

**Dogs May Arrive** any time prior to their scheduled time of judging. **Dogs not required for further judging will be excused.**

**Judges Will Not Wait for Any Dog Holding Up a Class.** Owners or agents alone are responsible for the presence of their dogs in the judging ring when their classes are called to be judged.

**All Dogs Present** must be held on leash or confined to their crates except when being judged or when in the exercising ring.

**No gasoline or diesel generators** are permitted inside any building or within 100 feet of any tent in which this dog show is conducted.

**As specified in Chapter 12, Section 4** of the AKC Rules Applying to Dog Shows, information contained on the entry form is required to be published in the club's show catalog. This information is also subject to publication in other media.

**Entry Fees** shall not be refunded in the event that a dog is absent, disqualified, excused by Veterinarian or Judge, or barred from competition by action of the event's Show Committee. If because of riots, wars, strikes, civil disturbances, national emergencies, health emergencies, and the dictates of law enforcement or of the owner(s) of the grounds and/or facilities or other acts beyond the control of the management it is impossible to open or to complete the show, no refund of entry fee will be made. Extreme weather conditions, such as, but not limited to, snow storms, hurricanes, lightning, extreme heat, heavy rains, or other circumstances including, but not limited to, the condition of the facilities or grounds and/or the ingress and egress from the grounds, must be considered for the health and safety of the dogs, exhibitors and spectators. The well-being of dogs, exhibitors and spectators is of paramount importance and, in the event it is necessary to cancel or stop the show before completion, no refund of entry fee will be made.

---

## Attention Exhibitors

Please leave grounds in the condition you found them. Place all trash in bags and deposit in the trash containers before leaving so we may have the grounds again in the future. Crates and all tables allowed at ringside only during the judging. **NO EXCEPTIONS.**

---

**IN THE INTEREST OF GOOD SPORTSMANSHIP, THE SHOW CHAIRPERSON, ASSISTANT SHOW CHAIRPERSON, HOSPITALITY CHAIRPERSON AND MEMBERS OF THEIR IMMEDIATE FAMILIES AS DEFINED IN THE GOLDEN RETRIEVER CLUB OF AMERICA SWEEPSTAKES GUIDELINES WILL NOT EXHIBIT AT THESE EVENTS.**



**SOUTH FLORIDA  
EXPO  
CENTER**  
*at the South Florida Fairgrounds*

9067 Southern Blvd.  
P.O. Box 210367  
West Palm Beach, FL 33421-0367  
(561) 793-0333  
Fax (561) 790-5210  
Website: [www.southfloridafair.com](http://www.southfloridafair.com)

The South Florida Fair has a limited number of Camping Spaces available for these events. They will be assigned on a first come/first served basis. Each camping space has electrical, water and sewer hook-ups. Campers must bring their own cords and connections. Please check in with security for your space assignment.

**Camping Cost: \$40.00 Per Night**

**Exhibitors & Motor homes - Enter Gate 2 for loading and unloading. All others Enter Gate 12.**

## Attention Exhibitors

**Show location** is available 7:00 A.M. Friday, March 12, 2010.

**Exhibitors** enter at Gate 2 for loading and unloading.

**Lights must be left on** while unloading.

**Camping will be permitted** at the Fairgrounds. Acres of parking available starting on **Thursday, March 11, 2010.**

**Absolutely NO tent camping allowed.**

**Hookups including** water, sewer & electricity available at **\$40.00 per night** on a first come, first served basis.

**Motor home sites** are narrow. X-pens must be set up within your site.

**Parking Each Day of the shows** - \$5.00.

**All parking fees** controlled by Fairgrounds.

**Paramedic** on site during show hours.

**The Event Committee** has the authority to change the rules for the safety and control of dogs & exhibitors.

**The Event Committee reserves the right** to require the stacking of crates and any other remedies it may deem necessary for consolidating space on a case-by-case basis at their discretion.

**DO NOT LEAVE DOGS IN CLOSED VEHICLES.**

**Aisles must be kept open** in the Grooming and Showing areas.

**The buildings will be locked at night.**

**Loss or Damage Disclaimer:** The club will assume NO responsibility for any personal injury or death to any person; theft, damages or loss of personal property nor injury or death of any animal either at or on the show grounds. It is expressly understood that every dog at these shows are in the care and custody and control of his/her owner or handler during the entire time the dog is on the show premises.

**Overnight Roaming Security** will be provided.

**Grooming allowed in designated areas only.**

**No dogs, feed bowls or grooming utensils** allowed in the restrooms.

**Only handicapped people** may use motorized chairs inside the buildings.

**No strollers, wagons, buggies, golf carts, skates, bicycles or scooters will be allowed inside the buildings.**

**No unentered dogs** will be allowed on the show grounds during show hours.

**Puppies under the age of six months** are prohibited on the show grounds during show hours of the All-Breed Shows.

**A parent is responsible for the welfare of their child and any damages done by their child.**

**The club** is not responsible for the products or actions of Vendors exhibiting at these shows.

**CRATES, GROOMING TABLES, RINGSIDE TABLES OR RESTING TABLES ALLOWED AT RINGSIDE ONLY DURING THE JUDGING OF THAT SPECIFIC BREED AND MUST BE REMOVED IMMEDIATELY UPON COMPLETION OF THAT SPECIFIC BREED.**

**All private exercise pens** must be set up in designated areas only.

**Roping off** or saving of crating space is not allowed.

**Exhibitors and handlers** will be held responsible for clean conditions in and around their crates and parking spaces.

**NO DOGS ARE ALLOWED TO BE LEFT IN THE BUILDING OVERNIGHT.**

**Anyone causing undue disturbance** will be asked to leave the Show Grounds.

**Private exercise pens** are not allowed in the Show Buildings.

**All dogs must be kept under control at all times.** Flexi-leads will not be allowed on the Show Grounds.

## Routes to the Event Site

**From North or South - I-95 to Southern Blvd. - Turn West and proceed West to Fairgrounds.**  
**Turnpike - Exit 97 - Southern Blvd. - Turn West and proceed to Fairgrounds.**

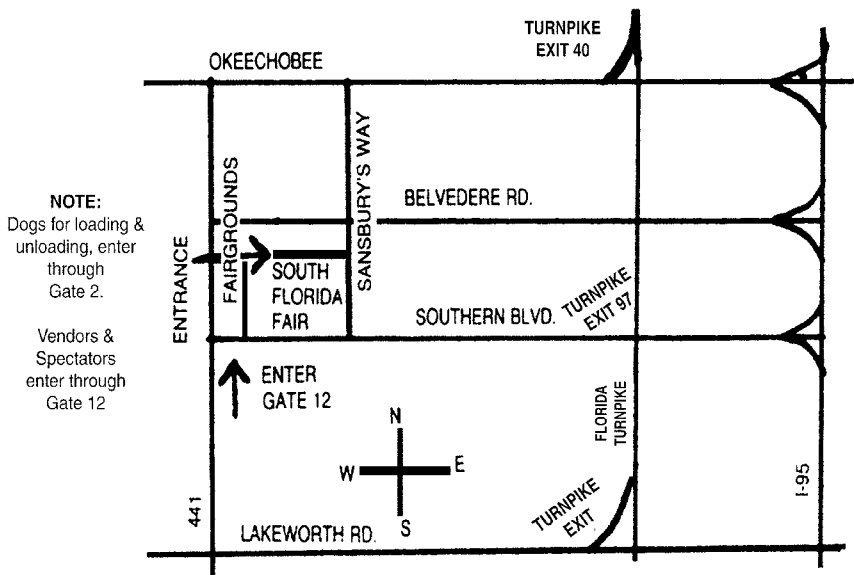

## Accommodations

 Call 1-800-780-5733 and use discount code 252688 or go to [infodog.com/travel/](http://infodog.com/travel/) to get the lowest rate with a price match guarantee.

### Hotels in Palm Beach County are at an all time low for our shows

The club has negotiated special room rates with the following dog friendly hotel that are at an all time low:  
**Days Inn**, 2300 West 45th St. (I-95 at 45th St.), West Palm Beach, FL 33407 ..... (800) 543-1613

\$75.00 per night - No Pet Fee

**LaQuinta Inn & Suites West Palm Beach**, 1910 Palm Beach Lakes Blvd., W. Palm Beach, FL 33409.... (561) 689-8540  
 \$87.00 per night - No Pet Fee or (800) 531-5900

**Holiday Inn Palm Beach Airport**, 1301 Belvedere Rd., West Palm Beach, FL 33405 ..... (561) 659-3881  
 \$89.00 per night - \$25.00 Pet Fee

**Residence Inn**, 2461 Metrocentre Blvd., West Palm Beach, FL 33407..... (561) 687-4747  
 \$109.00 per night - Includes Hot Buffet Breakfast - Large Suites with fully equipped kitchen (microwave, full-size fridge, stovetop) - No pet fee - Dogs 80 lbs. & under -

Reservations before February 28, 2010 reference "Dog Show" - After February 28, 2010 ask for Erika Hansen.

### Other Hotels

**Treetop Motel**, 5475 Lake Worth Rd., Greenacres, FL 33463..... (561) 965-2106  
**Motel 6 - Lantana**, 1310 W. Lantana Rd., Lantana, FL 33462 (No Pet Fee) ..... (561) 585-5833

**LaQuinta**, 5981 Okeechobee Blvd., West Palm Beach, FL 33417 ..... (800) 531-5900

**Comfort Inn**, 1901 Palm Beach Lakes Blvd., West Palm Beach, FL 33409 ..... (561) 689-6100

### Host Hotel - American Miniature Schnauzer Club, Inc.

Ask for AMSC block of rooms - \$25.00 Pet Fee

**Royal Inn**, 675 Royal Palm Beach Blvd., Royal Palm Beach, FL 33411 ..... (561) 793-3000

**Martinique Motor Lodge**, 801 Dixie Hwy., Lake Worth, FL 33460 ..... (561) 585-2502

Exhibitor, please be responsible, take care of rooms & hotel grounds so we will be invited back.



**Pedigree**

BRAND

**Food For Dogs**

***\*\*To collect your PEDIGREE® prize, the appropriate winning ribbon must be presented at the\*\*  
PEDIGREE® Booth by 5:00 P.M. on the day of the show***

*The Everglades Golden Retriever Club, Inc.  
invites all exhibitors and their guests to join us for a  
Specialty Celebration immediately following our events.*

*Palm Beach County Dog Fanciers, Inc.  
will offer CGC Testing at 11:00 A.M. and 3:00 P.M.  
on Saturday, March 13, 2010 & 11:00 A.M. Only on  
Sunday, March 14, 2010 and it will be open to all dogs,  
even if they are not entered.*

---

## **Special Notice Crating Regulations**

**Any dog in a crate** on the Show Grounds must be identified with Owner/Agent contact.

**Complete form below and attach to crate.**

**In an effort to accommodate exhibitors** within our limited space, we are allowing crates at ringside. All crates will be allowed ringside **ONLY** during judging of that breed and must abide by the following:

**Crates must be accompanied by an ID Tag with name of owner/handler:**

Dog crates must be removed immediately after judging. No dog crate will be allowed on the Show Grounds without an ID Tag. Please help us keep this privilege.

AGENT FOR THIS DOG .....

BREED OF THE DOG .....

RING TIME .....

# AKC Code of Sportsmanship

*PREFACE: The sport of purebred dog competitive events dates prior to 1884, the year of AKC's birth. Shared values of those involved in the sport include principles of sportsmanship. They are practiced in all sectors of our sport: conformation, performance and companion. Many believe that these principles of sportsmanship are the prime reason why our sport has thrived for over one hundred years. With the belief that it is useful to periodically articulate the fundamentals of our sport, this code is presented.*

- Sportsmen respect the history, traditions and integrity of the sport of purebred dogs.
- Sportsmen commit themselves to values of fair play, honesty, courtesy, and vigorous competition, as well as winning and losing with grace.
- Sportsmen refuse to compromise their commitment and obligation to the sport of purebred dogs by injecting personal advantage or consideration into their decisions or behavior.
- The sportsman judge judges only on the merits of the dogs and considers no other factors.
- The sportsman judge or exhibitor accepts constructive criticism.
- The sportsman exhibitor declines to enter or exhibit under a judge where it might reasonably appear that the judge's placements could be based on something other than the merits of the dogs.
- The sportsman exhibitor refuses to compromise the impartiality of a judge.
- The sportsman respects the AKC bylaws, rules, regulations and policies governing the sport of purebred dogs.
- Sportsmen find that vigorous competition and civility are not inconsistent and are able to appreciate the merit of their competition and the effort of competitors.
- Sportsmen welcome, encourage and support newcomers to the sport.
- Sportsmen will deal fairly with all those who trade with them.
- Sportsmen are willing to share honest and open appraisals of both the strengths and weaknesses of their breeding stock.
- Sportsmen spurn any opportunity to take personal advantage of positions offered or bestowed upon them.
- Sportsmen always consider as paramount the welfare of their dog.
- Sportsmen refuse to embarrass the sport, the American Kennel Club, or themselves while taking part in the sport.



**AMERICAN  
KENNEL CLUB™**