

58th Specialty Show & Sweepstakes  
(Unbenched)

**Collie Club of Greater Miami, Inc.**

(American Kennel Club Licensed)

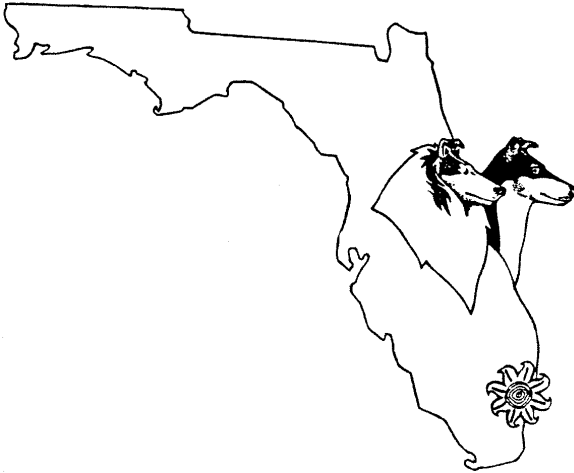

South Florida Fairgrounds  
Exposition Center  
9067 Southern Boulevard  
West Palm Beach, FL 33411

**Friday, March 12, 2010**

**All Judging Will Be Held Indoors**  
**Show Hours: 12:00 Noon - 8:00 P.M.**



**IS THE OFFICIAL SPONSOR OF THIS EVENT**



Ms. Nancy Comparato, Event Secretary  
c/o MB-F, Inc.  
P.O. Box 575, Brooksville, FL 34605-0575

## PROGRAM OF JUDGING

There are 11 dogs entered in this Specialty show with a total entry of 14. For your convenience, the following class divisions have been carefully tabulated; however, neither the Club nor the Superintendent/Show Secretary assumes responsibility for absolute accuracy.

### RING FOUR

JUDGE: Ms. Caroline Baines

5:00 PM

Specialty

3 - Collies Sweepstakes (1-2)

3 Total Dogs

### RING FOUR

JUDGE: Ms. Lori M. Montero

5:15 PM

Specialty

9 - Collies (Rough) 4-4-(0-1)

2 - Veteran Bitches

11 Total Dogs

### JUDGES

Ms. Caroline Baines (Ring 4) ..... 4536 S.W. 24th Ave., Ft. Lauderdale, FL 33312

Ms. Lori M. Montero (Ring 4) ..... 1709 Chamberwood Ct., Waxhaw, NC 28173

**IMPORTANT** - TRANSFER of dogs from regular classes to Best of Breed/Variety Competition (Ch. 11 Section 6, AKC Rules) MUST be made to the Superintendent/Show Secretary at least one half hour prior to the start of any regular conformation judging at this show.

#### Official Photographer

Kim Booth ~ Booth Photography, Inc.

P.O. Box 308, Williamston, MI 48895 (517) 655-4081

(Only the Official Photographer may be in the ring to take win pictures.)

#### Veterinarian in Attendance

Animal Hospital of Ft. Lauderdale

1630 E. Oakland Park Blvd.

Ft. Lauderdale, FL 33334

(954) 561-8777

#### Emergency Animal Clinic (5:00 P.M. to 8:00 A.M. - All Weekend)

\*Animal Emergency Clinic

3425 Forest Hill Blvd., West Palm Beach, FL 33406 (561) 433-2244

**\*Directions:** From Gate 12, turn Left, go South to Southern Blvd. Go East to Military Trail, turn Right, go South to Forest Hill Blvd. Turn Left onto Forest Hill & go one mile.

***"Exhibitors should follow their veterinarians' recommendation to assure their dogs are free of internal and external parasites, any communicable diseases, and have appropriate vaccinations."***

### NOTE:

To find out about any AKC event cancellations call the AKC Event Cancellation Hotline (877) 252-3229.

**A judge requesting** the use of a ramp must give reasonable notice to the Show Superintendent/Show Secretary prior to the day of the show. AKC approval is not required.

**Ramps may be used** in emergency situations to judge any breed. (In all but emergency situations, the exhibitor has no recourse. In an emergency situation, where use of a ramp is not indicated in the premium list, an exhibitor has the option of withdrawing their entry and receiving a refund.)

## Notice to All Attendees

The club reserves the right to remove any animal in distress from a parked vehicle, exercise pen or crate and all persons attending this dog show hereby waive any claim for damages against the club for such removal. An Event Committee Hearing will be convened to consider further disciplinary action if deemed warranted.

## Attention Exhibitors

Please leave grounds in the condition you found them. Place all trash in bags and deposit in the trash containers before leaving so we may have the grounds again in the future. Crates and all tables allowed at ringside only during the judging. NO EXCEPTIONS.

### NO PRACTICING ALLOWED IN RINGS AT ANY TIME.

**Dogs May Arrive** any time prior to their scheduled time of judging. **Dogs not required for further judging will be excused.**

**Judges Will Not Wait for Any Dog Holding Up a Class.** Owners or agents alone are responsible for the presence of their dogs in the judging ring when their classes are called to be judged.

**All Dogs Present** must be held on leash or confined to their crates except when being judged or when in the exercising ring.

**No gasoline or diesel generators** are permitted inside any building or within 100 feet of any tent in which this dog show is conducted.

**As specified in Chapter 12, Section 4** of the AKC Rules Applying to Dog Shows, information contained on the entry form is required to be published in the club's show catalog. This information is also subject to publication in other media.

**Entry Fees** shall not be refunded in the event that a dog is absent, disqualified, excused by Veterinarian or Judge, or barred from competition by action of the event's Show Committee. If because of riots, wars, strikes, civil disturbances, national emergencies, health emergencies, and the dictates of law enforcement or of the owner(s) of the grounds and/or facilities or other acts beyond the control of the management it is impossible to open or to complete the show, no refund of entry fee will be made. Extreme weather conditions, such as, but not limited to, snow storms, hurricanes, lightning, extreme heat, heavy rains, or other circumstances including, but not limited to, the condition of the facilities or grounds and/or the ingress and egress from the grounds, must be considered for the health and safety of the dogs, exhibitors and spectators. The well-being of dogs, exhibitors and spectators is of paramount importance and, in the event it is necessary to cancel or stop the show before completion, no refund of entry fee will be made.

## Special Notice Crating Regulations

Any dog in a crate on the show grounds must be identified with owner/agent contact. The club can provide crate stickers.

In an effort to accommodate exhibitors within our limited space, we are allowing crates at ringside. All crates will be allowed ringside ONLY during judging of that breed and must abide by the following:

**Crates must be accompanied by an ID Tag with name of owner/handler:**

Dog crates must be removed immediately after judging. No dog crate will be allowed on the show grounds without an ID Tag. Please help us keep this privilege.

AGENT FOR THIS DOG .....

BREED OF THE DOG .....

RING TIME .....

---

## Attention Exhibitors

Show location is available 7:00 A.M. Friday, March 12, 2010.

Exhibitors enter at Gate 2 for loading and unloading.

Lights must be left on while unloading.

Camping will be permitted at the Fairgrounds. Areas of parking available starting on Thursday, March 11, 2010.

Absolutely NO tent camping allowed.

Hookups including water, sewer & electricity available at \$40.00 per night on a first come, first served basis.

Motor Home sites are narrow. X-pens must be set up within your site.

Parking Day of the show - \$5.00.

All parking fees controlled by Fairgrounds.

Paramedic on site during show hours.

The Event Committee has the authority to change the rules for the safety and control of dogs & exhibitors.

The Event Committee reserves the right to require the stacking of crates and any other remedies it may deem necessary for consolidating space on a case-by-case basis at their discretion.

**DO NOT LEAVE DOGS IN CLOSED VEHICLES.**

Aisles must be kept open in the Grooming and Showing areas.

The buildings will be locked at night.

**Loss or Damage Disclaimer:** The club will assume NO responsibility for any personal injury or death to any person; theft, damages or loss of personal property nor injury or death of any animal either at or on the show grounds. It is expressly understood that every dog at this show is in the care and custody and control of his/her owner or handler during the entire time the dog is on the show premises.

Overnight Roaming Security will be provided.

Grooming allowed in designated areas only.

No dogs, feed bowls or grooming utensils allowed in the restrooms.

Only handicapped people may use motorized chairs inside the buildings.

No strollers, wagons, buggies, golf carts, skates, bicycles or scooters will be allowed inside the buildings.

No unentered dogs will be allowed on the show grounds during show hours.

Puppies under the age of six months are prohibited on the show grounds during show hours.

A parent is responsible for the welfare of the child and any damages done by the child.

The club is not responsible for the products or actions of Vendors exhibiting at this show.

**CRATES, GROOMING TABLES, RINGSIDE TABLES OR RESTING TABLES ALLOWED AT RINGSIDE ONLY DURING THE JUDGING OF THAT SPECIFIC BREED AND MUST BE REMOVED IMMEDIATELY UPON COMPLETION OF THAT SPECIFIC BREED.**

All private exercise pens must be setup in designated areas only.

Roping off or saving of crating space is not allowed.

Exhibitors and handlers will be held responsible for clean conditions in and around their crates and parking spaces.

**NO DOGS ARE ALLOWED TO BE LEFT IN THE BUILDING OVERNIGHT.**

Anyone causing undue disturbance will be asked to leave the show grounds.

Private exercise pens are not allowed in the show buildings.

All dogs must be kept under control at all times. For this reason, we strongly suggest that flexi-leads not be used on the show grounds.



### Food For Dogs

*To collect your PEDIGREE® prize, the appropriate winning ribbon must be presented at the PEDIGREE® Booth by 5:00 P.M. on the day of the show.*

## Routes to the Show

**From North or South**  
 - I-95 to Southern Blvd.  
 - Turn West and proceed West to Fairgrounds.  
**Turnpike - Exit 97**  
 - Southern Blvd. - Turn West and proceed to Fairgrounds.

**NOTE:**  
 Dogs for loading & unloading, enter through Gate 2.  
 Vendors & Spectators enter through Gate 12

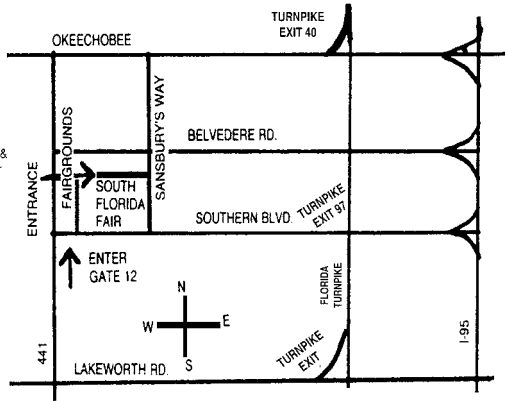

## Accommodations

Get Lowest Rates Here

Call 1-800-780-5733 and use discount code 252688 or go to [infodog.com/travel/](http://infodog.com/travel/) to get the lowest rate with a price match guarantee.

**Hotels in Palm Beach County are at an all time low for our shows**

- The club has negotiated special room rates with the following dog friendly hotel that are at an all time low:**  
**Days Inn**, 2300 West 45th St. (I-95 at 45th St.), West Palm Beach, FL 33407 ..... (800) 543-1613  
 \$75.00 per night - No Pet Fee  
**LaQuinta Inn & Suites West Palm Beach**, 1910 Palm Beach Lakes Blvd., W. Palm Beach, FL 33409.... (561) 689-8540  
 \$87.00 per night - No Pet Fee or (800) 531-5900  
**Holiday Inn Palm Beach Airport**, 1301 Belvedere Rd., West Palm Beach, FL 33405 ..... (561) 659-3881  
 \$89.00 per night - \$25.00 Pet Fee  
**Residence Inn**, 2461 Metrocentre Blvd., West Palm Beach, FL 33407..... (561) 687-4747  
 \$109.00 per night - Includes Hot Buffet Breakfast - Large Suites with fully equipped kitchen (microwave, full-size fridge, stovetop) - No pet fee - Dogs 80 lbs. & under -  
 Reservations before February 28, 2010 reference "Dog Show" - After February 28, 2010 ask for Erika Hansen.

### Other Hotels

- Treetop Motel**, 5475 Lake Worth Rd., Greenacres, FL 33463..... (561) 965-2106  
**Motel 6 - Lantana**, 1310 W. Lantana Rd., Lantana, FL 33462 ..... (561) 585-5833  
 No Pet Fee  
**LaQuinta**, 5981 Okeechobee Blvd., West Palm Beach, FL 33417 ..... (800) 531-5900  
**Comfort Inn**, 1901 Palm Beach Lakes Blvd., West Palm Beach, FL 33409 ..... (561) 689-6100  
**Royal Inn**, 675 Royal Palm Beach Blvd., Royal Palm Beach, FL 33411 ..... (561) 793-3000  
**Martinique Motor Lodge**, 801 Dixie Hwy., Lake Worth, FL 33460 ..... (561) 585-2502

**Exhibitor, please be responsible, take care of rooms & hotel grounds so we will be invited back.**



9067 Southern Blvd.  
 PO Box 210367  
 West Palm Beach, FL 33421-0367  
 (561) 793-0333  
 Fax (561) 790-5210  
 Website: [www.southfloridafair.com](http://www.southfloridafair.com)

The South Florida Fair has a limited number of Camping Spaces available for this event. They will be assigned on a first come/first served basis. Each camping space has electrical, water and sewer hookups. Campers must bring their own cords and connections. Please check in with security for your space assignment.

**Camping Cost: \$40.00 Per Night**